

This document has been promulgated by the Department of Defense as the military standard to limit the selection of the item, product or design covered herein in engineering, design and procurement. This standard shall become effective not later than 90 days after the latest date of approval shown.

FED SUP CLASS
5940

ROUND END

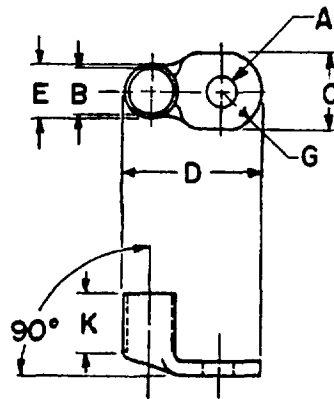

SQUARE END

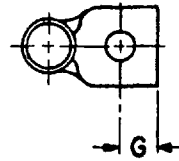

DASH NO.	FINISH	DASH NO.	FINISH	WIRE SIZE AWG NOM	STUD SIZE	HOLE A DIA		B DIA	C	D	E DIA	G	K
						MIN	MAX						
1	050-6274	11	050-6276	10	8	.167	.179	.143	1/4	5/8	3/16	3/16	11/32
2	050-6278	12	050-6280	8	10	.193	.205	.186	3/8	13/16	1/4	7/32	11/32
3	050-6282	13	050-6284	6				.238	7/16	15/16	5/16	1/4	3/8
4	050-6286	14	050-6288	4	1/4	.258	.285	.289	17/32	1-1/8	3/8	9/32	7/16
5	050-6290	15	050-6292	2				.347	5/8	1-7/32	7/16	11/32	1/2
6	050-6294	16	050-6296	0	5/16	.320	.347	.401	3/4	1-3/8	1/2	13/32	9/16
7	050-6300	17	050-6299	00				.460	13/16	1-9/16	9/16	7/16	11/16
8	050-6301	18	050-6303	000	3/8	.383	.410	.519	29/32	1-11/16	5/8	1/2	25/32
9	050-6305	19	050-6307	0000				.559	1	1-7/8	11/16	17/32	27/32
10	050-6309	20	050-6311	250MCM				.660	1-3/16	2-1/8	13/16	5/8	31/32

MATERIAL: ELECTROLYTIC SEAMLESS COPPER TUBING.

FINISH: HOT TIN DIP OR ELECTRODEPOSITED TIN ALL OVER, MINIMUM THICKNESS .0005 INCHES.

NOTES: 1. ALL DIMENSIONS IN INCHES. TOL: FRACTIONAL $\pm 1/64$, DEC $\pm .010$ UNLESS OTHERWISE SPECIFIED.

2. REMOVE ALL BURRS.

3. REFERENCED DOCUMENTS OF ISSUE IN EFFECT ON DATE OF INVITATION FOR BIDS SHALL APPLY.

4. THE MS PART NUMBER CONSISTS OF THE MS NUMBER PLUS THE DASH NUMBER.

Note: When Government drawings, specifications or other data are used for any purpose other than in connection with a definitely related Government procurement operation, the United States Government there by, incurring no responsibility, it is not to be construed as an authorization, either expressed or implied, in any way to reproduce or to disseminate the information contained herein, or to make any other use of the same, without the prior written permission of the Government.

(B)

CUSTOMERS ORD SHIPS	OTHER INT. A-Sec, TC, CE N-Wep, DockS AF-	MILITARY STANDARD TERMINAL, LUG, SOLDER TYPE, COPPER TUBING, ONE HOLE, 90°	MS35448
---------------------------	--	---	----------------

PROCUREMENT SPECIFICATION
MTI-T-157-50

SUPPLEMENT:

SHEET 1 OF 1

APPROVED 5 JULY 55 REVISED A 23 JULY 56, (B) 10 February 1961.